



CUBE PRODUCT SPECIFICATIONS



Mission Room's unique, interactive, immersive displays have been developed over a 10 year period. We have supplied to major projects and companies in the AEC, rail, highways and construction sector.

Originally optimised to display 360° site video and imagery, the systems have evolved to include BIM, 4D, real-time data and project dashboards. All Windows and web-based applications can run on our systems.

- Four screen display system
- Ultra short-throw projection
- 7680 x 1080 resolution
- Driven by a single Windows PC
- Interactive touch pen technology
- Integrated audio system
- Mission Room software pack
- Free-standing structure
- Quick install
- Relocation service available
- Custom branding options
- Concertina style / removal of fourth wall available
- Custom sizing and specification available

Systems can be bought, rented or leased. We also offer a rent-to-buy option to reduce the risk of introducing the technology.



STANDARD SIZES / DIMENSIONS

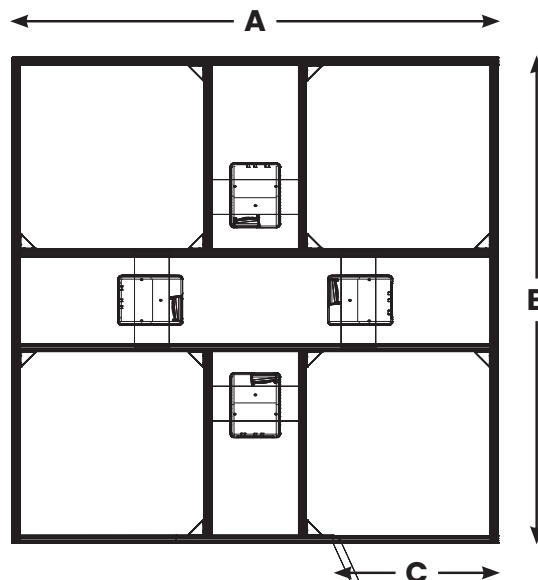
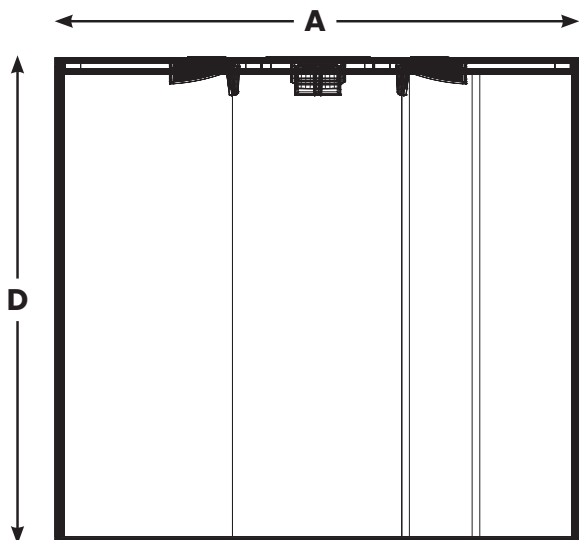

| | Description | Measurement |
|----------|-------------|-----------------|
| A | Width | 2800mm / 3000mm |
| B | Depth | 2800mm / 3000mm |
| C | Door width | 900mm |
| D | Height | Min 2300mm |

FOURTH WALL OPTIONS

- Concertina 4th wall
- Fixed 4th wall with door (900mm door minimum for wheelchair access)
- Remove 4th wall for a 3 screen system

Bespoke sizes available for height and footprint. Footprint limit is about 3300mm subject to ceiling height as the projection can end up quite low.

MINIMUM PC SPECS

Operating System (OS): Windows 10 or higher
 Processor (CPU): Intel i5 or equivalent
 Memory (RAM): 32GB minimum
 Graphics Card (GPU): NVIDIA GTX 4070
 Boot Drive: 1TB
 Storage Drive: 1TB
 Spare unobstructed PCIE x4 slot (must be wired)

Option for client sourced PC to this spec or client Windows build install.



INCLUDED SOFTWARE



LAUNCHER is an adaptive interface for operating Windows software using a touch pen. Optimise applications for the multiscreen display system, inbuilt annotation utility and customisable interface options.



TOUCH allows your Mission Room system to have Touchscreen functionality. It uses specialist cameras and an infra-red pen to allow the user to control the displays.

Bespoke software solutions are available.