



## CINE PRODUCT SPECIFICATIONS



Mission Room's unique, interactive, immersive displays have been developed over a 10 year period. We have supplied to major projects and companies in the AEC, rail, highways and construction sector.

Originally optimised to display 360° site video and imagery, the systems have evolved to include BIM, 4D, real-time data and project dashboards. All Windows and web-based applications can run on our systems.

- Three screen display system
- Ultra short-throw projection
- 5760 x 1080 resolution
- Driven by a single Windows PC
- Interactive touch pen technology
- Integrated audio system
- Mission Room software pack
- Free-standing structure
- Quick install
- Relocation service available
- Custom branding options
- Custom sizing and specification available

Systems can be bought, rented or leased. We also offer a rent-to-buy option to reduce the risk of introducing the technology.



## STANDARD SIZES / DIMENSIONS

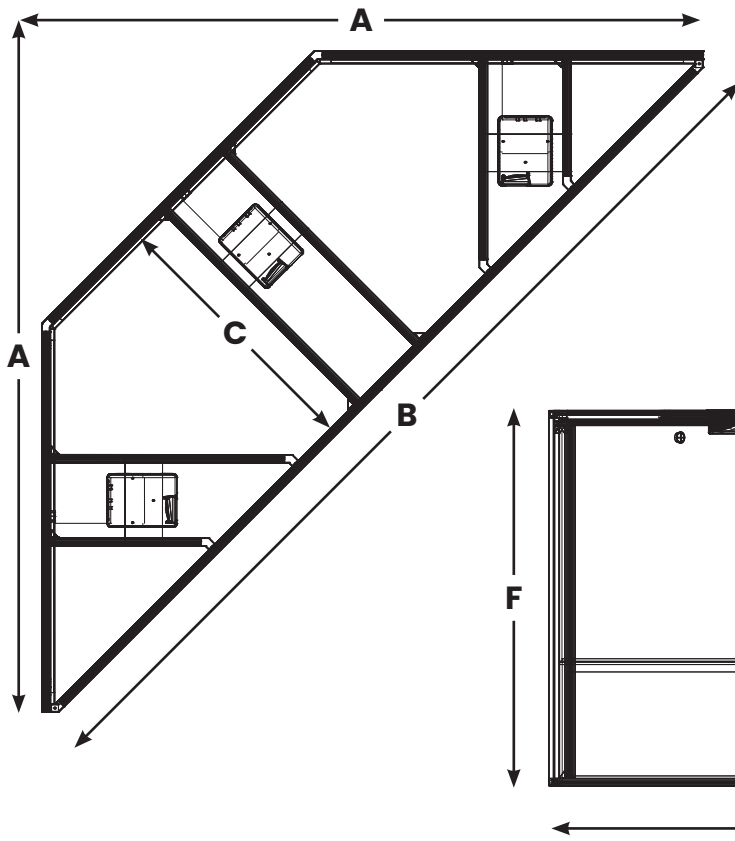

	Description	Measurement
A	Front edge to corner	3527mm
B	System width	4990mm
C	System depth	1531mm
D	Individual screen width	2000mm
E	Graphic height	740mm
F	Total system height	2240mm (allow 2270mm for clearance)

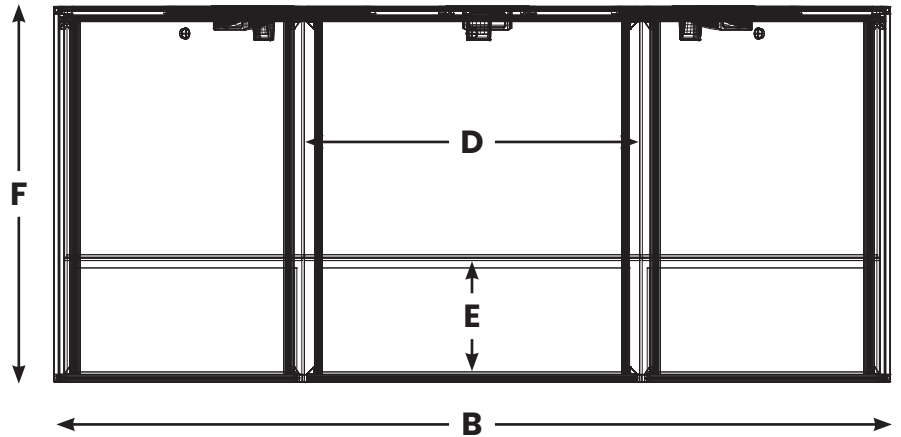

## MINIMUM PC SPECS

Operating System (OS): Windows 10 or higher  
 Processor (CPU): Intel i5 or equivalent  
 Memory (RAM): 32GB minimum  
 Graphics Card (GPU): NVIDIA GTX 4070  
 Boot Drive: 1TB  
 Storage Drive: 1TB  
 Spare unobstructed PCIE x4 slot (must be wired)

Option for client sourced PC to this spec or client Windows build install.



## INCLUDED SOFTWARE



**LAUNCHER** is an adaptive interface for operating Windows software using a touch pen. Optimise applications for the multiscreen display system, inbuilt annotation utility and customisable interface options.



**TOUCH** allows your Mission Room system to have Touchscreen functionality. It uses specialist cameras and an infra-red pen to allow the user to control the displays.

Bespoke software solutions are available.